



LCHA Roundup

www.larimerhorseman.org

LARIMER COUNTY HORSEMAN'S ASSOCIATION

July, 2011

PoloCross



Susan Kurzweil

Hi Everyone:

Who is tired of being home and watching your horse sit in the pasture? I know I'm ready to do some riding and according to a rumor I heard, there is a chance, if there are no new cases of the Equine Herpes Virus, that we may be able to resume our horseback riding activities by late June.

Keeping that slight unknown in mind, please consider attending our upcoming LCHA fun activity of Polocross on Saturday, July 23rd. It's going to be an early activity at 8:00 am, so we can use the cooler part of the day.

We will be meeting at Kay Thomson's arena in Berthoud. Please plan to arrive at 7:30 am, so we can be ready to ride at 8:00 am. This event will run for approximately two hours, with the first hour covering instruction and practice and the second hour splitting into teams and giving it a try. Most of the time you will be walking or trotting, but please wear your helmet.

Please RSVP by July 10th using email to Susan at Susankurz@aol.com or give me a call at 970-663-6738. All equipment will be provided and the cost is \$20 per person. Come, have some fun, and learn something new!

Editor's Note:

Here is some information on the sport from Wikipedia:

Polocross is a team sport that is played all over the world. It is a combination of polo and lacrosse. It is played outside, on a field (the pitch), on horseback. Each rider uses a cane stick to which is attached a racquet head with a loose, thread net, in

In this month's issue . . .

<i>PoloCross</i>	<i>page 1</i>
<i>Directions to Kay Thomson's Arena for Polocross</i>	<i>page 3</i>
<i>LCHA Is Going to the Fair - Will You Help?</i>	<i>page 3</i>
<i>Welcome to the New Fiscal Year for LCHA!</i>	<i>page 4</i>
<i>Special Notice Regarding Your LCHA Membership</i>	<i>page 5</i>
<i>Trail Minders Tame the Lion</i>	<i>page 5</i>
<i>Calendar of Events</i>	<i>page 7</i>
<i>Trail Rides in 2011</i>	<i>page 7</i>
<i>CLASSIFIED ADS</i>	<i>page 9</i>

Your Advertising can be here.
Rates: \$20 for full page per issue; \$10 for half page per issue.
Contact Hugh Templeton, editor of LCHA Roundup, for more information.

Paid Advertising

which the ball is carried. The ball is made of sponge rubber and is approximately four inches across. The objective is to score goals by throwing the ball between the opposing team's goal posts.

Anyone who can ride a horse can play Polocross, which also helps improve riding skills. All ages and abilities are encouraged to play...



For more information about the sport, you can search for "polocross" on Google or other search engines.

By the way – we won't expect anyone to dress in a uniform, to look as good in the sport as these pictures and drawings show, or to be an expert at polocross after only one hour of instruction for you and your horse. We do hope that you will have lots of fun.

Editor

Directions to Kay Thomson's Arena for Polocross

From north, south, or east

- Take the Berthoud exit from I-25.
- Turn west on CO 56.

- Go about 1 mile on CO 56 to CR 7.
- Turn Left on CR 7.
- Go about 1 mile on CR 7 to CR 42.
- Turn right on CR 42.
- Go about one-half mile on CR 42, and then turn right into the driveway for 2563 WCR 42.

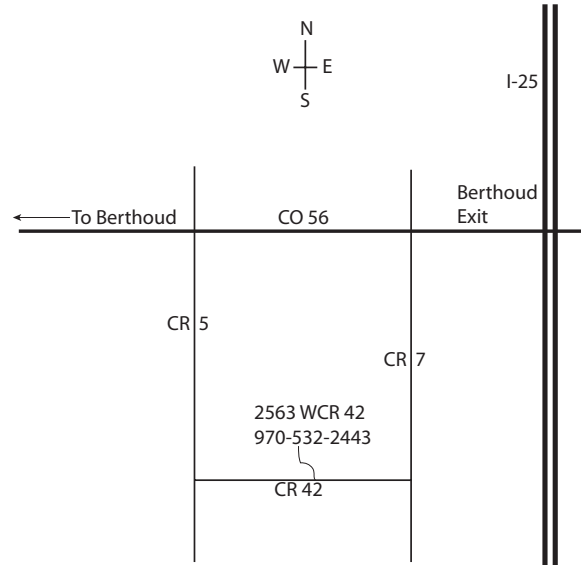

From west

- Take CO 56 east from Berthoud.
- Follow CO 56 to CR 5 (about 2 miles from the east edge of Berthoud at County Line Road).
- Turn right onto CR 5.
- Go about 1 mile on CR 5 to CR 42.
- Turn left on CR 42.
- Go about one-half mile on CR 42, and then turn left into the driveway for 2563 WCR 42.

LCHA Is Going to the Fair – Will You Help?



August 1- 8, 2011

Hello to all, I hope the start of this wonderful summer finds you and your horse(s) healthy and in Great Spirit!

This year's Larimer County Fair is coming up in several weeks and our fair booth is always a fun thing to be a part of. We need volunteers to work in the booth. As a volunteer, you get to meet a lot of people and share all the

things that LCHA represents and does for our county plus the activities we have to offer to our members.

We'll also need volunteers to help set the booth up, and to take the booth down.

Can you spare a few hours in August? Would you like a chance to come to the Larimer County Fair and spend some time talking to prospective members and folks who have horses or are interested in the world of horses? And there's no fee to come to the fair, so lots of folks should come by.

Here are the time slots for this year's fair. There are no events going on Wednesday or Thursday so the booth will not be manned.

We will be in the Ranch Way Indoor arena. If you are interested in volunteering to help man our booth, please email me for the time you would like to work. There will be two people at the booth for each time slot so if you are volunteering for yourself, I will arrange to put someone to work with you.

On Sunday morning, Aug 8th from 6:30 AM to 9 AM, they serve a free breakfast.

Please contact Gary York 970-203-0144 or my.stall2@gmail.com

THANKS for volunteering!

2011 LCHA Fair Booth Schedule

Day/Date	Time Slot	Event in Arena
Sun, July 31	2 - 4 PM	4H Horse Show, English Classes
	4 - 8 PM	4H Horse Show, English Classes
Mon, Aug 1	6 - 8 PM	Musical Freestyle Larimer County Open Roping
	8 - 10 PM	
Tues, Aug 2	8 AM - 11 AM	4H Horse Show, Western Classes 4H Working Ranch Horse Classes
	11 AM - 2 PM	
	2 - 5:30 PM	
	5:30 - 9 PM	
Thurs, Aug 4	7 - 10 PM	Larimer County Barrel Racing and Roping
Fri, Aug 5	8 -12am	Mule Show Mule and Draft Pull
	12 -3:30 PM	
	3:30 - 7 PM	
	7 - 10 PM	

Day/Date	Time Slot	Event in Arena
Sat, Aug 6	9 -12:00 AM	Junior Rodeo
	12:00 AM - 3:30 PM	Junior Rodeo
	3:30 to 7 PM	Junior Rodeo
	7 to 10 PM	Larimer County Open Barrel Race

Gary York

Editor's Note

This is one of the really great activities we support. It is the best chance all year to present LCHA to the public, to let them know we exist, and that we are a great group. We also have a good time talking to folks who walk by, telling them about LCHA and our horses, and just enjoying the conversations we find ourselves in. We depend on our volunteers to make our Fair appearances a positive experience. Sign up, and have fun while supporting LCHA.

Welcome to the New Fiscal Year for LCHA!

Welcome to the new Board of Directors. These are members who are willing to set aside time to bring value to the horse community. The new board members and their phone numbers will be in the August newsletter (this is July's newsletter which went to print before the election picnic.) We are very open to all members' input, so give us feedback and ideas. We hope to make this program year – 2011/2012 – a great year for the horse.

The last two months, with the scare of the EHV-1 virus, is a good example of the use of our e-list. Trying to put this news and ever changing updates on the web site would have been a full time job for TJ. Through the LCHA simple list, we were informed by caring local veterinarians and members forwarding the Colorado State veterinary reports. Join the e-list for updates, emergency information, and LCHA activities location changes (picnic). If you want to receive current LCHA information, you MUST be on the e-list. Join today by contacting Bonnie Templeton at 970-622-0982.

We are all volunteers for this great organization. Every member tries to do quality work, whether working on the

trails, riding the trails, programs, fund raisers, training activities, or helping the county. Join in saying "I am proud to be a LCHA member and volunteer."

"The simple things done with quality are a doorway to horsemanship."

Ed Odgers

This quote referred to a number of activities done on a daily basis when we are around our horses. Examples:

- Noticing how one prepares the bridle or halter before approaching the horse.
- Noticing the horse's expression while approaching.
- Noticing the activities going on around you before and during the task at hand.

Noticing, noticing, noticing, noticing is what the horse is all about. The simple things done with quality are a doorway to horsemanship.

Kim Andrews
LCHA President 2010/2011

Worth Repeating

Special Notice Regarding Your LCHA Membership

The LCHA membership year runs from June 1 through May 31. Now is the time to renew your membership for the 2011/2012 LCHA year.

You should receive a post card soon reminding you to renew your membership, and you will see another reminder in the next two or three newsletters. We don't want you to miss all the great activities planned for the year just because you forgot to renew.

So stick around. Take a moment now to send your renewal check to

Larimer County Horseman's Association
P.O. Box 270375
Fort Collins, Colorado 80527-0375

Thanks, and see you around.

Trail Minders Tame the Lion

Lion Gulch trail, that is. Yes, 10 trail minders and guests met at the Lion Gulch trail head on June 4 for trail maintenance:

- Mary Detweiler
- Cary Ford

LCHA Roundup is a newsletter of the Larimer County Horseman's Association (LCHA), P.O. Box 270375, Fort Collins, CO 80527-0375.

*Editor: Hugh Templeton, 970-622-0982
hught@lpbroadband.net*

The LCHA Board of Directors:

President, Kim Andrews 970-613-0121
Vice President, Ted Newport 970-397-9591
Secretary, Susan Kurzweil, 970-663-6738
Treasurer Gary York.....'970-203-0144
Immed Past Pres, Jillian L'Ecuyer..... 970-568-9526

Committee Managers and Members at Large:

TJ Newport, Web Master..... 970-397-6986
Hugh Templeton, Emergency Evacuation 970-622-0982
Racheal Cohen, Membership 720-273-4798
Toni McConnell, Membership 970-217-0287
Bonnie Robinson, Program 970-217-1113
Bonnie Templeton, At Large..... 970-622-0982

LCHA Roundup thanks the following persons for their contributions:
Rachael Cohen— preparing the newsletter for mailing.

If you have ideas, comments, or questions about LCHA, horses, the horse industry in Larimer County, or this newsletter, send them to the editor.

- Joseph Ford
- Stacy Geer
- Susan Kurzweil
- Maddy Murphy
- Ted Newport
- TJ Newport
- Mark Reinke
- Hugh Templeton

We had a spectacularly beautiful day, almost cloudless with warm temperatures, but not too hot.

After introductions and tool demonstrations, we started “up” trail – well, actually, the first part of the trail leads downhill to the stream that runs down Lion Gulch. We saw little work to do until we had reached almost a half mile. We blocked a side trail or two (the Forest Service prefers that users stay on the main trail), and blocked off some wider areas where the trail had begun to slide down a hill, leaving it potentially unsafe.

Everybody helped, making the work light and fast.

We continued up the trail, and found some areas in which trail traffic and mother nature had “gullied” the trail – beaten a depression on the trail tread between the hillside on one side and a mound of berm on the other side. We removed the berm, putting the mound of earth on the trail tread and tamping it down so that water would flow directly across the trail rather than flowing down the trail, which causes erosion of the trail itself.



Berm removed from the downhill side of the trail and put into the trail tread to stop trail erosion in a gully; the tree trunk defines the edge of the trail so that users won't wander off the side of the trail tread



Another section of berm removal; the tree trunks and branches define the edge of the trail so that users won't wander off the side of the trail tread. A check dam (the log across the trail) holds the downhill end of the repaired trail tread in place as the trail starts more sharply downhill.

We fixed other sections of the trail that needed berm removal. By lunch time, everyone was ready for a break and a chance to have our sandwiches. Thanks to Subway of Berthoud for donating a 6-inch sandwich for each volunteer on our trail maintenance trips. This time the sandwiches were turkey, and they tasted good after a morning of work.

Before we reached our lunch spot, we noticed another section of trail that needed a different type of solution to a gully. After lunch we returned to that section and built 5 new check dams (these are barriers directly across gullied trail). We use check dams when the gully is deep or in a location in which we can't remove berm. The dams slow down the water that flows down the trail; when the water slows down, it drops sediment it is carrying. Eventually, the sediment builds up in the trail tread, filling in the gully.

It actually works that way!

After the check dams, we headed back to the parking lot, and then to the Dairy Delite in Lyons for a treat for ourselves and some quiet chat before going home.

It was a really good day on the trail. We had a good time outdoors on a beautiful trail, we enjoyed each other's company, and we accomplished important work on the trail.

Trail Maintenance Schedule for 2011

Day/Date	Trail	Arrive
Sat/ July 16	Nomad Trail, Horsetooth Mountain Park Hugh Templeton, 970-622-0982	9:00 AM
Sat/ Aug 13	Lion Gulch Hugh Templeton, 970-622-0982	8:30 AM
Sat/ Sept 17	Lion Gulch Hugh Templeton, 970-622-0982	8:30 AM

If you have questions regarding LCHA Trail Minders, or if you want to sign up for a specific trail maintenance trip, call or

email Hugh Templeton at 970-622-0982 or hught@lpbroadband.net.

Calendar of Events

Events in 2011

Date	Day	Event	Location	Contact	Time
July 23	Sat	LCHA Fun Ride – Polo Cross – and Fundraiser	Kay Thomson's Arena	Susan Kurzweil, 970-663-6738	Arrive 7:30 AM, Ride 8:00 AM
Sept 24	Sat	Poker Ride	Lory State Park	Kim Andrews 970-613-0121	Arrive at 10:00, Ride at 10:30
Dec 3	Sat	Christmas Caroling on Horseback	Berthoud (details to be announced)	TBA	Meet at Noon, ride at 12:30

Trail Rides in 2011

The Trail Ride Coordinator is TJ Newport (970-397-6986). If you would like to suggest a trail ride location, or if you would like to lead a trail ride, call TJ.

Sign In

If you intend to participate in a trail ride, please notify the ride leader(s) at least two days in advance:

For A Trail Ride On ...	Notify the Ride Leader(s) by ...
Saturday	Wednesday evening
Sunday	Thursday evening

For any trail ride, be ready to ride at the time shown on this schedule, unless otherwise noted.

Trail Rides for 2011

Date	Day	Location	Leader	Pace	Limit	Arr	Ride
July							
July 16	Sun	Lady Moon LCHA members only	Pat Carey 970-224-4532 Bring a lunch	W, T	8	9:00	9:30
July 17	Sun	Mt Margaret LCHA members only	Susan Kurzweil (663-6738) and Kim Andrews (613-0121) Bring a lunch	W, T, C	None	9:30	10:00
July 29	Fri	Lion Gulch LCHA members only	Kay Thomson 970-532-2443, or 970-443-7111 Bring a lunch	W, T	None	8:30	9:00
July 30	Sat	Bobcat Ridge LCHA members only	Stacey Geer 970-635-2695 or 970-988-7996 Bring a lunch	W, T, C	6	10:00	10:30
August							
Aug 14	Sun	Beaver Meadows LCHA members only	Pat Carey 970-224-4532 Bring a lunch	W, T	8	9:00	9:30
Aug 21	Sun	Lory State Park LCHA members only	Stacey Geer 970-635-2695 or 970-988-7996 Bring a lunch	W, T, C	None	10:00	10:30
Aug 27	Sat	Hermit Park LCHA members only	Kim Andrews 970-613-0121 Bring a lunch	W, T, C	None	9:30	10:00
September							
Sept 18	Sun	Crozier Mountain LCHA members only	Susan Kurzweil 663-6738 Bring a lunch	W, T	3 trailers	9:30	10:00
Sept 24	Sat	Poker Ride	Kim Andrews 970-613-0121	W, T, C	No limit - come one, come all	10:00	10:30
Sept 25	Sun	Red Mountain LCHA members only	Pat Carey 970-224-4532 Bring a lunch	W, T	6	9:00	9:30
October							
Oct 15	Sat	Pawnee Grasslands Open to LCHA members and their guests Bring a lunch	Kay Thomson 970-532-2443 or 970-443-7111	W, T, C	No limit - come one, come all	9:30	10:00

Trail Rides for 2011

Date	Day	Location	Leader	Pace	Limit	Arr	Ride
Oct 22	Sat	Hall Ranch LCHA members only Bring a lunch	Stacey Geer 970-635-2695 or 970-988-7996 Bring a lunch	W, T	8	10:00	10:30
Oct 23	Sun	Eagles Nest LCHA members only Bring a lunch	Pat Carey 970-224-4532 Bring a lunch	W, T	None	9:00	9:30
December							
Dec 3	Sat	Christmas Caroling on Horseback, Berthoud This event is open to the public.	Kay Thomson 970-532-2443	W	No limit - come one, come all	noon	12:45

W = Walk; T = Trot; C = Canter

CLASSIFIED ADS

Better yourself, better your horse! Not enjoying the joyful and abundant partnership you always dreamed of? Get the support you need to thrive with your horse at Mountain Rose Horsemanship Training. Teaching people to teach horses in the pursuit of partnership! Visit www.mountainrosetraining.com for more information.

For Sale Hand tied rope halters with lead rope. All sizes – from pony to draft. I can do halters for llamas also. Choose the color you want. A single halter and lead costs \$20. For multiple halters, call for pricing. Call Ted Newport Jr. (T.J.) 970-397-6986

For Sale Nice group of kind, gentle, and nice looking horses for sale, professional training, age 2 and up. See them on our web site @ www.Bridle-Bit.com
Also – Individual lessons, clinics, training from start to finish. Call 970-454-3061 or visit our web site at www.Bridle-Bit.com

Hoof Trimming Experienced & Certified Natural Hoof Care Practitioner. I will pull shoes and trim your horse for barefoot comfort. I carry a good inventory of hoof boots and I offer boots at the best prices around. Call Keith Jacobson, 970-391-1838 or visit my website www.naturalhoofcareofcolorado.com for more information.

Horsemanship/Symmetry, Balance, Moving with your Horse. Private lessons. Clinics on trail riding. Gaited horse. Cow working. Dressage. Ground work. Joe and Kim Andrews. 970-613-0121. www.mountainmagicranch.com

Leather Care Shop Leather repair and restoration. Saddle, tack cleaning and conditioning. Leather Artist; crafts, pictorial, and custom horse commissions. Joe and Kim Andrews 970-613-0121

Natural Barefoot Trims for Your Horse! Certified Natural Hoof Care Practitioner can trim your horse's hooves the way Nature intended! I can also offer you the latest in hoof boots available: EasyCare Gloves. Let's work together to make your equine's hooves as strong and healthy as they can be. Call or email Silja Knoll, (970) 402 5104 or siljaknoll@yahoo.com

Problem-Solving For Your Horse Customized training available at your home or barn to improve teamwork between you and your horse. Identify causes of unwanted behavior and work on solutions to keep you safe and enjoy your horse. Groundwork, English, and western disciplines. For more info, see www.freelyequine.com.

Professional Vacation Care for your horses, dogs, cats and all other animals at your home. Quality, meticulous care is what CES provides so you will have peace of mind while you are away from home. Complete Equine Services also offers Lay-up care at your facility, Training Assistance, Riding/ Exercising horses, Beginning Riding Lessons, and Long/ Short-term feeding and cleaning contracts. Please visit CES at www.CompleteEquineServices.com for more detail on the services we provide or call Erin at 970-391-6457.

Ride Indoors at the Esh Training Center! Tired of the snow, wind and cold? Ride in our 100 x 200 indoor arena for a low haul-in fee of \$10. We also offer: colt starting, training, lessons and clinics. Visit our website at: www.paulesh.com or give us a call at 970-567-7505.

Riders Wanted. We're fat but lovable Tennessee Walkers. Pat Parrelli approach required. No spurs, only good riding skills. We do rein. You have to convince our partner that you can stay out of our mouth, and have a good seat. He may even have a saddle for you to use. We've been on lots of trails, pack trips, and attended many equine classes. If you're horseflesh challenged, but want to get involved in LCHA or

just ride the mountains of Wyoming, go on LCHA activities, and can at least help with transportation expenses, send email to Skip Eshelman at hexsigns@gmail.com

Stallion at Service: Cuttin Colonel, Sire: Colonel Freckles, Dam: Cutters Pretty. Foundation pedigree speaks for itself. Outstanding disposition and athletic ability. NCHA Certificate of Ability, 1984 GNMCHA Maturity finalist, NRHA and AQHA performance point earners and money earning producer. Contact Mike Disque, TD Quarter Horses 303-229-3516, 970-532-9907, spirithorsemtn@msn.com

The Card Shop

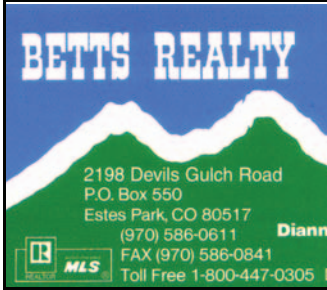

BETTS REALTY
 2198 Devils Gulch Road
 P.O. Box 550
 Estes Park, CO 80517
 (970) 586-0611
 FAX (970) 586-0841
 Toll Free 1-800-447-0305



Dianne Betts, GRI, CRS
 Broker/Owner
 Dianne@DianneBetts.com



Complete Equine Services
Peace of Mind for You AND Your Horses!
970-391-6457
 Erin Wilson-Kaufman, Owner
 1931 ECR 58
 Fort Collins, CO 80524
www.CompleteEquineServices.com
 erin@completeequineservices.com



EQUINE MEDICAL SERVICES
 3021 West County Road 64 - Fort Collins, CO 80524

Excellence in Performance Horse Care
 Including field & in-clinic reproductive services & surgery

For Appointments and Information
(970) 568-9445
Fax (970) 568-0705
www.emsvet.com

Dr. Allen Landes

Freely Equine, LLC



Kristin Schuett
 Western & Hunt Seat Instruction
 Horse Training
 Trail Lessons

CHA

Improving teamwork between you and your horse.
970-443-2758 E-mail: kristin@freelyequine.com
 Serving Northern CO Web: www.freelyequine.com



High Plains Natural Hoof Care, LLC
Silja Knoll
 Certified Natural Hoof Care Practitioner
970.402.5104
siljaknoll@yahoo.com
www.highplainsnaturalhoofcare.com

LAPORTE ANIMAL CLINIC
 MARTA DEAN, D.V.M. ANDREW DEAN, D.V.M.



SMALL ANIMALS
 AVIAN
 EXOTICS
 HORSES (MOBILE AND HAUL-IN)

PH: 970-490-1999
 FAX: 970-407-7977

CONVENIENTLY LOCATED IN THE OVERLAND TRAIL SHOPPES
 3333 CTY RD. 54G, UNIT G, P.O. BOX 527, LAPORTE, CO 80535
 ON THE CORNER OF OVERLAND TRAIL & OLD HWY 287 (54G)

MIKE BRASHEAR HORSE TRAINING



Mike & Laura Brashear
 13540 WCR 10
 Fort Lupton, CO 80621
 (303) 857-6297
www.MikeBrashear.com

Specializing in RANCH HORSE VERSATILITY & PERFORMANCE HORSES



Mountain Magic Ranch
 Horse Training Riding Lessons
 Joe and Kim Andrews
 101 So. C.R. 29 Loveland, CO 80537
 (970) 613.0121
mountainmagicranch.com



Emily Johnson
 OWNER & INSTRUCTOR

13770 DAVIS LANE
 LONGMONT, CO 80504
 PHONE: 303.877.5767
WWW.MOUNTAINROSETRAINING.COM
EMILY@MOUNTAINROSETRAINING.COM

The Card Shop

My Source, LLC
 First Class RV, Trailer Renovation
Paul Thomson
 Master Carpenter
 Master Cabinet Maker
 Over 30 years experience
 2563 CR 42
 Berthoud, Colorado
 970-581-8977
 Floors, walls, cabinets, custom built-ins... I do it right!
 Call now for an estimate.



NATURAL HOOF CARE
 OF COLORADO
KEITH JACOBSON
 CERTIFIED NHC PRACTITIONER
 970-391-1838
 BAREFOOT TRIMS FOR COMFORT AND PERFORMANCE
 WWW.NATURALHOOF CAREOF COLORADO.COM

Precious Memories
 Pet Cemetery and Crematory
 5815 E. Hwy 14
 Fort Collins, CO 80524
 (970) 482-7557



Rocky Mountain RIDER
 Regional All-Breed Horse Magazine — Since 1993
Natalie Riehl
 Publisher/Editor
 PO Box 995 • Hamilton, MT 59840
 406-363-4085 • 888-747-1000
 Fax 406-363-1056
 editor@rockymountainrider.com
 www.rockymountainrider.com



SPOTTED FEVER RANCH
 Rick & Pat Binger
 9057 ECR 26
 Loveland, CO 80538
 Registered Paint Horses
 www.spottedfeverranch.com
 rick@spottedfeverranch.com
 970-222-3656

The Tack Trunk
 The Right Tack at the Right Price
Anne Cooney
 Owner
 970-227-6566
 asha_cooney@yahoo.com

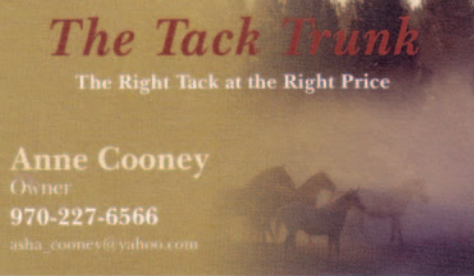

Resident Realty
Bonnie Robinson
 Broker/Associate
 8010 CR 5, Suite 102
 Fort Collins, CO 80528
 970-223-3361 Direct
 970-377-4109 Fax
 bonnie.robinson@msn.com
 970-217-1113 Mobile



WADE TREE RANCH
 Randall Davis
 * Working Cow Horse
 * Ranch Horse Versatility
 * Starting Colts and Wild Mustangs
 Cell: 970-301-2995
 www.wadetreeranch.com



Larimer County Horseman's Association
ALL-AMERICAN Horse Feed
TRIPLE CROWN Nutrition, Inc.
 10% Discount Card
 Redeemable at:
 Ranch-Way Feeds Retail Store
 546 Willow, Fort Collins, CO
 970-482-1662
 www.Ranch-Way.com
 Please present your current LCHA membership card at time of purchase



For All Your Trailer Needs SALES
PJ TRAILERS
 FACTORY OUTLET
 (970) 532-5113
 2421 N. 1st St. Berthoud, CO 80513
 Trades & Consignments Welcome
 \$0 Down
 6 Months
 Same as Cash



EQUINE VETERINARY SERVICES
 OF NORTHERN COLORADO, PC
 Stephanie A. Brauli, DVM, PhD, Dipl. ACVIM
 Shawn N. Dixon, DVM, CVA
 (970) 472-6363
 P.O. Box 1026 LaPorte, CO 80535
 www.evsnortherncolorado.com
 Personalized Care for Your Horse



2010 Extreme Mustang Makeover Competitor
Colorado Reinsman
 No Gimmicks, No Gadgets, just a solid foundation
 www.coloradoreinsman.com
Sean Davies
 seand62@hotmail.com (970) 980-6485

WALKING OUT WEST
 Gaited Horse Training
 Lessons
 Clinics
 Debbie Garfield, Trainer
 (303) 725-3551 Cell
 Email: walkingoutwest@yahoo.com



39 Years of Service

LCHA Roundup



*Larimer County Horseman's Association
P.O. Box 270375
Fort Collins, Colorado 80527-0375*