

**HACC CENTRAL PENNSYLVANIA'S  
COMMUNITY COLLEGE  
HARRISBURG CAMPUS**

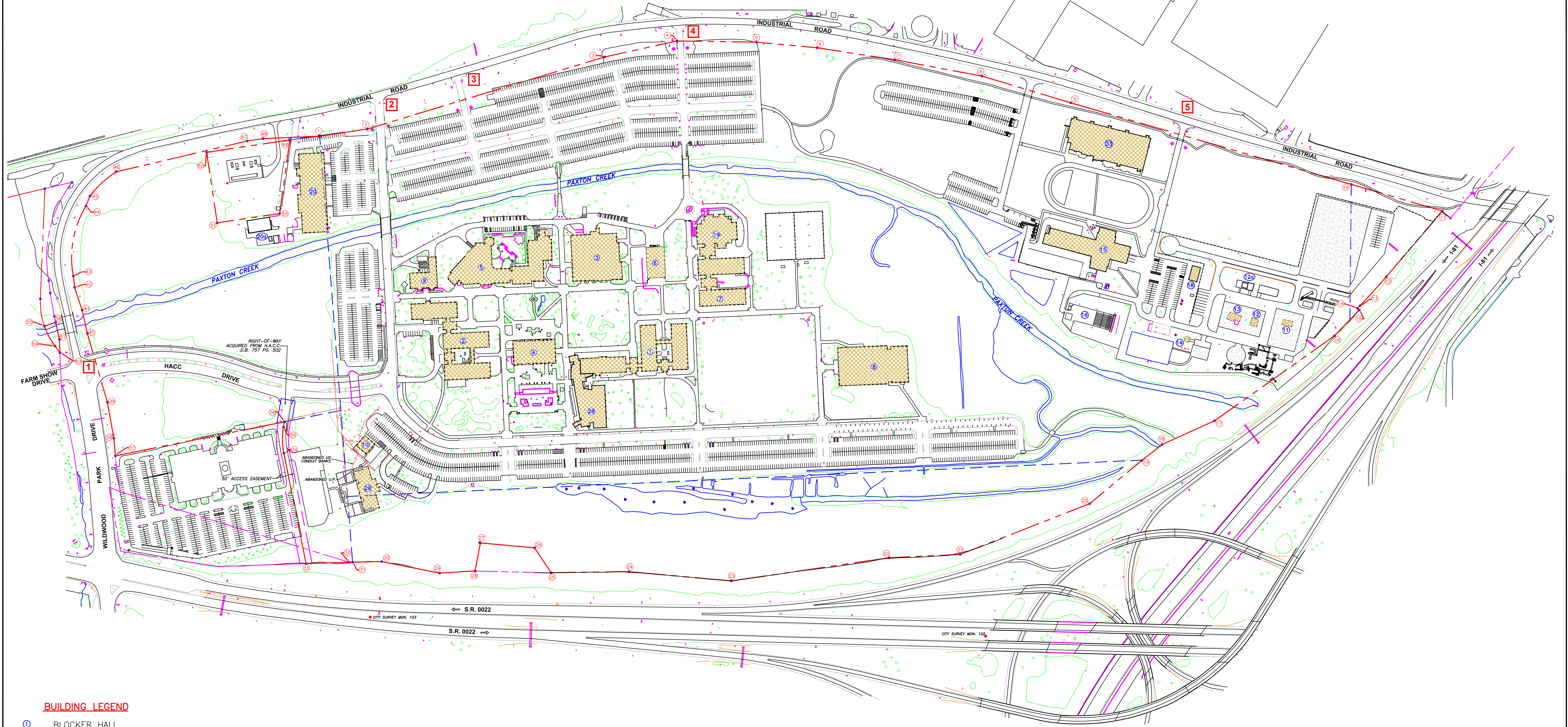

**BUILDING LEGEND**

- ① BLOCKER HALL
- ② WHITAKER HALL
- ③ COOPER STUDENT CENTER
- ④ McCORMICK LIBRARY
- ⑤ LEHRMAN ARTS CENTER
- ⑥ OVERHOLT BOOKSTORE
- ⑦ HALL TECHNOLOGY BUILDING
- ⑧ EVANS PHYSICAL EDUCATION BUILDING
- ⑨ STABLER MEDIA SERVICES CENTER
- ⑩ SWITCHGEAR BUILDING
- ⑪ TRAINING TOWER
- ⑫ SMOKE BUILDING
- ⑬ NORTH PAVILION
- ⑭ BURN BUILDING
- ⑮ PUMP HOUSE
- ⑯ NORTH HALL --- PUBLIC SERVICES TRAINING CENTER
- ⑰ SATR-SHOOTING RANGE
- ⑱ TRAILERS
- ⑲ TED LICK ADMINISTRATION BUILDING
- ⑳ COLLEGE SERVICE CENTER
- ㉑ GREENHOUSE
- ㉒ SELECT MEDICAL HEALTH EDUCATION PAVILION
- ㉓ GRACE MILLIMAN POLLOCK CHILDCARE AND EARLY CHILDHOOD EDUCATION CENTER
- ㉔ LAW ENFORCEMENT COMPLEX

**ENTRANCE DRIVE LEGEND**

- 1 MARY SACHS ENTRANCE (GOLD)
- 2 ALUMNI ENTRANCE (BURGUNDY)
- 3 ANNIVERSARY ENTRANCE (SILVER)
- 4 WILDWOOD ENTRANCE (GREEN)
- 5 PUBLIC SAFETY ENTRANCE (BLUE)

**REVISION NOTES:**

1. REVISION NO. 1 INCLUDED UPDATING THE MAPPING WITH AS-BUILT INFORMATION FOR BUILDING NUMBERS 6, 12a, 20a, 28, AND 29 PER FIELD SURVEYING BY SKELLY AND LOY IN OCTOBER 2006.
2. REVISION NO. 2 INCLUDED UPDATING THE MAPPING WITH AS-BUILT INFORMATION FOR BUILDING NUMBER 30 AND THE PUBLIC SAFETY CENTER PER FIELD SURVEYING BY SKELLY AND LOY IN SEPTEMBER 2013 AND RED-LINED DRAWINGS PROVIDED TO SKELLY AND LOY FROM CONTRACTOR.

DRAWING NO. <b>C-1</b>	SHEET <b>1</b>
<b>PLAN FOR</b> <b>HACC CENTRAL PENNSYLVANIA'S COMMUNITY COLLEGE</b> <b>HARRISBURG CAMPUS</b> CITY OF HARRISBURG	
<b>SITE PLAN</b>	
DESIGN DATE BAS 08/21/02 DFTSM BAS 08/21/02 CHR WTS 08/21/02 APY	SCALE: " = 200' DATE 9/18/13 11/30/06
DESCRIPTION 1 MAPPING UPDATED WITH AS-BUILT INFORMATION 2 MAPPING UPDATED WITH AS-BUILT INFORMATION	BY BAS BAS
<b>SKELLY AND LOY, INC.</b> <b>ENGINEERS-CONSULTANTS</b> 449 EISENHOWER BOULEVARD, SUITE 300 HARRISBURG, PENNSYLVANIA (717)232-0593 (800)892-6532 FAX (717)232-1799	
JOB NUMBER: 1601256	DATE: AUGUST 21 2002